

UNIT 503 - 5350 SAYWARD HILL CRESCENT

1784 SQ. FT.

9' CEILING HEIGHT

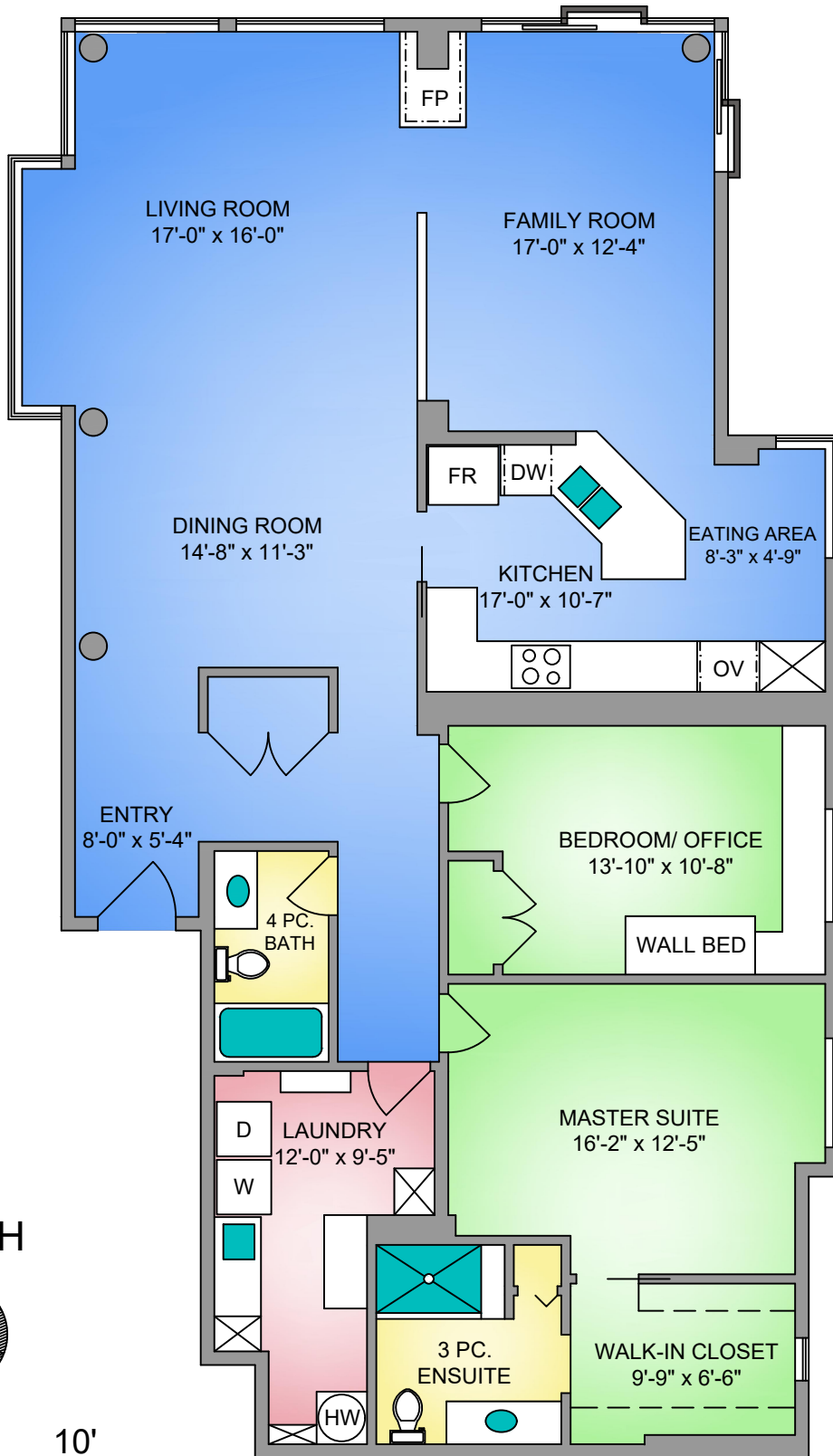

NORTH

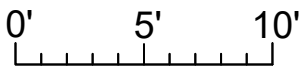
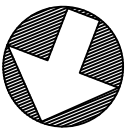

SCALE

UNIT 503 - 5350 SAYWARD HILL CRESCENT
APRIL 14, 2021

PREPARED FOR THE EXCLUSIVE USE OF THE MACLEOD GROUP
PLANS MAY NOT BE 100% ACCURATE, IF CRITICAL BUYER TO VERIFY.

FLOOR	AREA (SQ. FT.)
	FINISHED
FIFTH	1784



250-884-9753
matt@propermeasure.com
www.propermeasure.com

Sotheby's
INTERNATIONAL REALTY

Canada